



Studio Hydro-Québec

TECHNICAL RIDER

GENERAL INFORMATION

Address	1182 Saint-Laurent Boulevard, Montreal, QC H2X 2S5
Telephone	514-871-9883
Email	info@monumentnational.com
Operations Direction	direction.mn@ent-nts.ca
Technical Direction	technique.mn@ent-nts.ca
Maximum capacity	80-150
Production Office	None, but an area can be set up for this purpose.
Control Booth	On the mezzanine floor
Dressing rooms (Green Room)	Ground floor, situated around the venue
Safety	<p>Technical personnel must wear steel-toed footwear.</p> <p>Wearing a safety helmet is mandatory when working at a height.</p> <p>A safety harness is mandatory for anyone working at a height greater than 10' measured from the floor.</p>

VENUE INFORMATION

BLEACHERS

This venue, commonly known as the “Black Box,” is rented without preconfigured seating. A variety of audience layouts are possible, for example:

Italian Style:

This basic Italian-style audience layout consists of a set of 30 risers, 3' X 6' each, arranged into six rows. Depending on the intended stage setup, our riser system can accommodate up to 90 chairs, and we can put an additional 20 chairs in the gallery, for a total of 110 seats.

Cabaret Style:

For cabaret-style seating, we can offer the following furniture:

- 30 tables, 20” in diameter
- 8 tables 15” in diameter
- 110 chairs

DIMENSIONS

Wall to wall	Width:	43'
	Depth:	52'
Between galleries	Width:	30'
	Depth:	44'
Grid height	26'
3 bridge cranes	Clearance beneath bridges:	19'

1 perimeter corridor that can serve as backstage and wings.

LOADING DOCK

A street-level loading dock is located at 1170 Saint-Laurent Boulevard and provides access to a freight elevator with a load capacity of up to 12,000 lb (5,455 kg). The elevator serves the basement, ground floor, trap room, and stage.

Freight elevator dimensions

Width:	92”
Height:	95”
Depth:	22’

Studio access for sets: Door dimensions

Width:	60’
Height:	80”

STAGE CURTAINS

4 Borders:

Height: 5'
Width: 30'
Black, flame-retardant (FR) velvet

8 Legs:

Height: 17'2"
Width: 13'
Black FR velvet

2 Backdrops:

Height: 17'2"
Width: 18'
Black FR velvet

2 Peated curtains, 50% fullness

Height: 17'2"
Width: 18'
Black FR velvet

1 Black Scrim

Height: 17'2"
Width: 30'

1 White Cyclorama

Height: 17'2"
Width: 45'
Full scrim

10 Contour curtains – Parterre

Height: 6'10"
Width: 10"
Black FR velvet

18 Contour curtains – Mezzanine

Height: 6'5"
Width: 10"
Black FR velvet

9 Contour curtains – Gallery

Height: 6'2"
Width: 10'
Black FR velvet

RISERS

30 3' x 6' platforms (can only be used for bleachers) with 16", 32", 48", 64", 80" and 96" legs

ON DEMAND:

40 3' x 6' platforms (can be used to create a raised stage or bleachers)
Includes sets of legs: 8", 12", 16", 24", 32", and 40"

BACKSTAGE FACILITIES

2 Dressing rooms for 2 people
2 Dressing rooms for 4 people
1 Green Room
1 utility room (includes iron and ironing board)

VIDEO EQUIPMENT

**All video equipment is available upon request only, fees may apply.*

VIDEO

2 Panasonic projectors PT-RZ 990 (10K)
2 Standard lens
2 Lens ET-DLE085

MISCELLANEOUS

Converter CAT 6/HDMI cables on demand.

LIGHTING EQUIPMENT

CONSOLE AND DIMMERS

- 1 ETC ION Xe 20 console
 - 2 screen display ports (with mouse, keyboard and sACN board -> Node link)
- 144 Dimmers 2.4 kW, GTL 20 amp. output terminals
- 1 Node Chauvet Net X – II 8 Universe
- 3 Opto Chauvet Datastream 4 Out / 1 In / 1 Thru (2 Fixed in the distro + 1 Moving)

RIGGING POSITIONS

- 3 Bridge cranes (clearance under bridges: 19' from the ground up)
- 1 Permanent tubular grid at 26'
- 2 Permanent ground-level linesets close the walls (north and south sides)
- 2 Permanent linesets under the gallery near the stage (north -south and east-west)

LIGHTING

- 9 Lekos ETC 19° 575 Watts
- 22 Lekos ETC 26° 575 Watts
- 26 Lekos ETC 36° 575 Watts
- 12 Lekos ETC 50° 575 Watts
- 40 Fresnels 1kW Strand Fresnelite 6" with barn doors
- 8 Fresnels 2kW Strand Fresnelite 8" with barn doors
- 26 PAR ETC 575W VN / N / Med / Wide

Fixtures Leds / Moving Lights :

**All LED fixtures and moving lights are available upon request only, fees may apply.*

- 2 Robin 300 Led Wash Robe
- 2 Mini - Pointe Robe
- 12 Colorado 3 Solo
- 10 ColorSource Cyc
- 4 ColorSpot 575 AT Robe

Lentilles PAR :

- 26 Narrow
- 24 Wide
- 16 Medium
- 21 Very Narrow

Canon ETC :

- 5 19 degrés
- 2 26 degrés
- 6 36 degrés
- 5 50 degrés

Accessories :

- 12 ETC Drop-iris
- 24 Type B gobo holders

ELECTRICAL CONNECTIONS

Technical gallery:

- 1 Cam-Lock
 - 200A
 - 120/208V
 - 3 phases
- 1 Distro Theatrix 100A SD124
 - 3 phases principal circuit breaker on the Camlock IN
 - 1 to 3 phases switches
 - Circuits 24X 20A U-Ground 125V
- 4 Splay Socapex x6 female U-Ground
- 4 Splay Socapex x6 male U-Ground (permanent in the distro)

MISCELLANEOUS

- 17 Side arms
- 20 Floor bases
- 8 Booms (various heights)
- 1 Genie Lift AWP-25S

Cables:

Complete set of cables, Socapex and twofers as needed.

MISCELLANEOUS (RENTAL FEES)

- 1 MDG ATMOSPHERE Fog Generator (smoke machine)

Gels:

Variety of Lee and Rosculux gels.

SOUND EQUIPMENT

MIXING CONSOLES AND EQUIPMENT

- 1 Allen & Heath SQ-7
- 2 Allen & Heath DX168 digital S-Link stage box
- 1 Meyer Sound Galileo 408

MICROPHONES, DI AND ACCESSORIES

- 2 Shure SM-58
- 1 Shure Beta52
- 3 Shure SM-57
- 4 Sennheiser e604
- 1 Sennheiser e602
- 2 Sennheiser e614
- 4 CAD Astatic 201R

- 2 Tall Atlas mic stand
- 7 Tall boom stand
- 4 Short boom stand
- 5 Table stand
- 3 Shure drum clip (A56D)

- 3 Mono passive DI
- 1 Stereo passive DI
- 1 Switch mic for stage manager

SOUND SYSTEM

- 4 QSC K10.2 (at four corners by default, movable)
- 2 Meyer USW-1P
- 4 QSC K10.2
- 6 Yamaha MSR-400 with stands and O-rings
- 2 Mackie CR4 (Booth monitors)
- 1 Multi-zone paging system for dressing rooms and/or lobby

COMMUNICATION SYSTEM

- 1 2 Channel wired intercom base station (Clear-Com)
- 1 Wired speaker-microphone station
- 10 Wired intercom beltpacks
- 10 Wired intercom headsets
- 1 Hollyland Solidcom C1 HUB master base station for wireless intercoms
- 8 Hollyland Solidcom C1 wireless intercom headsets

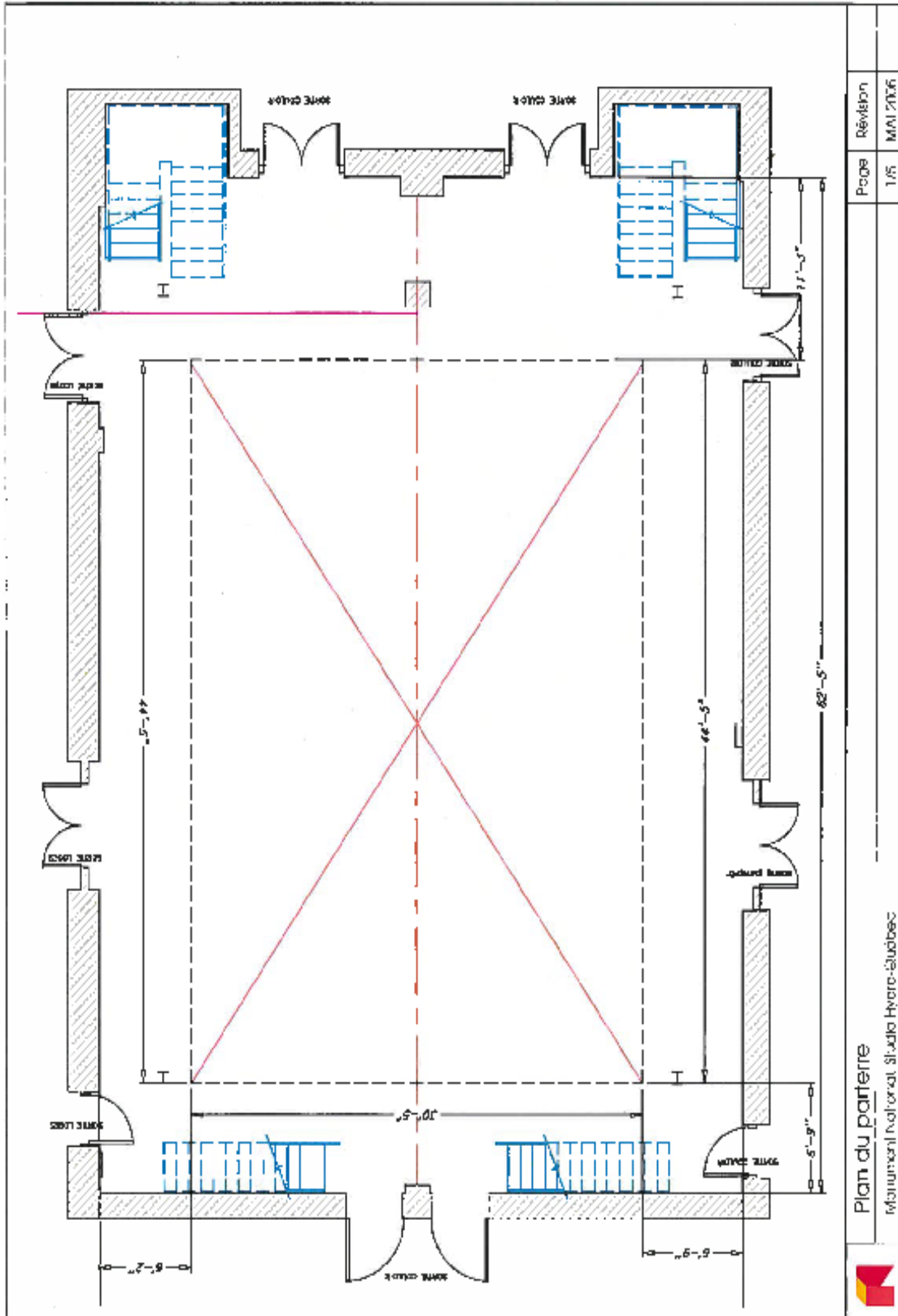

Page	Revision
1/5	MAR 2006

Plan du parterre
Municipalité nationale, Studio Hydro-Architect

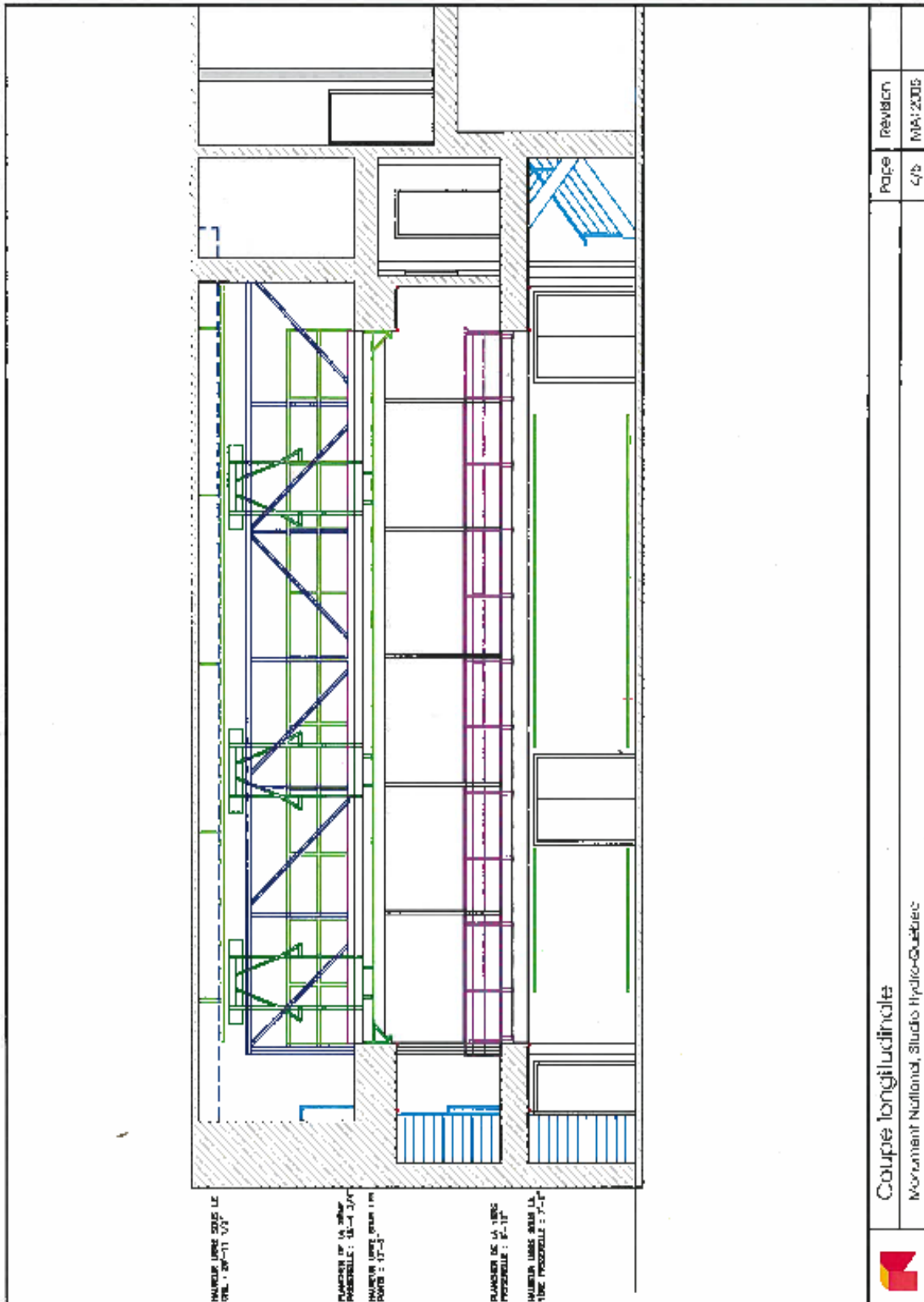

The Monument-National forms one of two campuses of the National Theatre School of Canada.

- Located near the corner of Saint-Laurent and René-Lévesque Boulevards, it is within walking distance of both the Saint-Laurent and Place-d'Armes metro stations.
- The main entrance and Box Office are located at 1182 Saint-Laurent Boulevard; The reception staff and backstage entrance is located at 1170 Saint-Laurent Boulevard.
- It was built in 1893 and entirely renovated in 1993 for its centennial anniversary.